



Knobs and Knolls

October 2016

In This Issue

Nature Center Expansion

[Nature Center Expansion](#)

[In Memory: Wallace Coffey](#)

[Fall Nature Center Activities](#)

[Wildlife Weekend 2016](#)

[Nature Center Expansion](#)

[Progress in Photos](#)

If you haven't been to the Park recently, you've missed the dramatic transformation happening at the Nature Center. Since it began in May, construction has progressed smoothly and dramatically. (See photos on the last page of this newsletter.) Now that it's completely under roof, most of the work involves completing the interior. We still anticipate that construction of the addition will be complete by the end of December. Then the real fun begins, as we start to equip the classroom and install the many new displays that are planned. If all proceeds on schedule, we will have a grand opening of the new building sometime in the late spring or early summer.

Once construction and outfitting of the new building is completed, the current floor space will be completely renovated and updated. Hopefully this will happen in the late summer and fall of 2017. The two phases of construction have been planned in order to minimize disruption of daily Nature Center activities; however, we anticipate that some closures will be necessary as work proceeds later this year.

We're especially excited about several features of the new facility:

- ❖ a 1200 square foot classroom/meeting room fully equipped for audiovisual presentations, classroom work, and social events;
- ❖ an aquarium array with much larger tanks (for happier and healthier live specimens) and a central work space that can be used as a teaching area as well;
- ❖ two large dioramas utilizing live and taxidermy specimens - one featuring local woodland mammals, amphibians and reptiles, the other featuring local birds;
- ❖ a hands-on learning space for young children, featuring an interactive "ecosystem wall";
- ❖ two crawl-through learning experiences for young children – a cave and a beaver lodge;
- ❖ ample parking (including handicap spaces) immediately adjacent to the main entrance;
- ❖ full handicap accessibility with a central elevator;
- ❖ additional work space for Nature Center employees and volunteer naturalists.

Continued on next page

Nature Center Expansion (Continued)

We continue to work closely with Ed Hackley and the Nature Center/Parks and Recreation staff to bring all of this to life. Ed has proposed an impressive array of exhibits demonstrating the wide biodiversity diversity of the Park and our region. To see some of his concept designs, see the pages that follow.

However, full implementation of his proposed designs depends entirely on our ability to raise \$375,000 over the next several months. Having applied to numerous local and regional foundations, we are now reaching out to businesses and individuals who can make sizable contributions. But we also need your help to make this dream a reality. No contribution is too small; and all donors who wish to be, will be recognized for their contributions.

Contributions can be made by mail using the form below, or by credit card or PayPal account via our website, www.friendsofsteelecreek.org. You may also contact us by e-mail at mail@friendsofsteelecreek.org or by telephone at 423-764-8828.

If you are a member of a civic organization and would like to have Jeremy Stout and one of our Board members speak to your group about the Nature Center expansion project, contact us at mail@friendsofsteelecreek.org.

Donate Today

All donations are fully tax deductible to the extent allowable by law.

Your donation will help to assure that the enlarged and enhanced Nature Center at Steele Creek Park is a destination worth coming back to again and again – for learning in a fun and exciting way about the natural wonders of the Park and our region.

Use the form below to contribute today, or go online to pledge your donation today!

The Nature Center at Steele Creek Park Expansion Fund Contribution Form

Name: _____
Phone: _____
E-mail: _____
Address: _____

Makes checks payable to:

Friends of Steele Creek Nature Center and Park

Mail to:

P.O. Box 1763, Bristol, TN 37620

Unless you request that it remain anonymous, your **tax deductible** gift will be gratefully acknowledged and published in the *Bristol Herald Courier* in conjunction with the grand opening, targeted for spring of 2017. Please indicate donor name as you would like it to appear.

Sponsorship Levels

____ \$25,000 Oak (Champion)	____ \$1,000 Poplar (Partner)
____ \$10,000 Maple (Benefactor)	____ \$500 Pine (Supporter)
____ \$5,000 Chestnut (Sponsor)	____ \$100 Magnolia (Contributor)
____ \$2,500 Hemlock (Patron)	____ <\$100 Holly (Friend)

Donations at the Hemlock Level and higher will be noted on permanent signage at the Nature Center. Pledges will be accepted for gifts of \$2,500 and above, with payment due in full on or before December 31, 2016.

[Back to Page 1](#)



1. Entry/Orientation/Seating
2. Director's Office
(With Upper & Lower Floor Security Cam Monitor)
3. Story-Telling Footprints
4. Hands-On Live Species Lab
5. Every Animal Has A Story
6. Birder's Hillside
7. Crawl-Through Beaver Dam
8. Bird Swarm Walkway
9. Waterfowl
10. KidZone
11. Interactive Gallery#1
12. Employee Workspace
13. Employee Restroom

Upper Floor Topic Plan View
Design Development



Partners/Consultants:

The Friends of Steel Creek Park
and the management, S&B, of
The Nature Center at Steel Creek Park

Project:

May 25, 2016
Interactive Exhibits for the I&S 2nd
Room of The Nature Center at Steel Creek Park

Client:

The Friends of Steel Creek Park

Revisions:

1	6/24/2016	41
2	7/7/2016	51
3		61

Concept Document Only
Plans ownership of all creative content
and/or materials created in-house, non-
confidential information not included

DRWG. NO. **1**

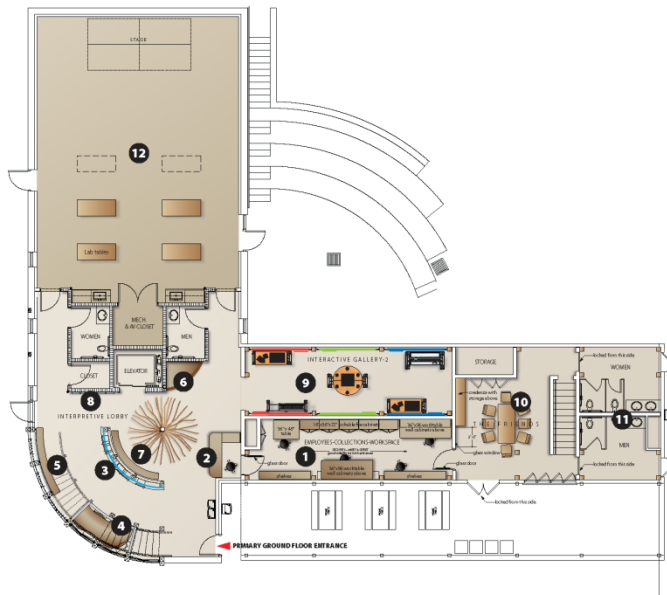

1. Reception, Collections,
Security, Workspace
(With Upper & Lower Floor Security Cam Monitor)
2. Reception
3. Interactive Geology Wall
4. Crawl-Through Cave
5. Interpretive View
6. Giant Sloth Skeleton
7. Indigenous Aquatic Species
8. Invasive Aquatic Species
9. Interactive Gallery #2
10. "The Friends" Area
11. Public Restrooms
12. Programmable Classroom

Ground Floor Topic Plan View
Design Development



Partners/Consultants:

The Friends of Steel Creek Park
and the management, S&B, of
The Nature Center at Steel Creek Park

Project:

May 25, 2016
Interactive Exhibits for the I&S 2nd
Room of The Nature Center at Steel Creek Park

Client:

The Friends of Steel Creek Park

Revisions:

1	6/24/2016	41
2	7/7/2016	51
3		61

Concept Document Only
Plans ownership of all creative content
and/or materials created in-house, non-
confidential information not included

DRWG. NO. **3**



Every Animal Has A Story Interactive Wall Scale: 3/4"=1'-0"



Build A Pond Community Interactive Wall Scale: 3/4"=1'-0"



Plan View: 3/8"=1'-0" Interactive Wall

Animals Diorama & Interactive Wall Design Development



Partners/Consultants:

The Friends of Steel Creek Park
and the management staff of
The Nature Center at Steel Creek Park

Project:

May 25, 2016
Interpretive Exhibits for the 1st & 2nd
floors of the Nature Center at Steel Creek Park

Client:

The Friends of Steel Creek Park

Revisions:

1/16/2016
2/17/2016

Concept Document Only
Finality of design is not guaranteed
unless otherwise noted in this scope
of work or in a separate addendum

7

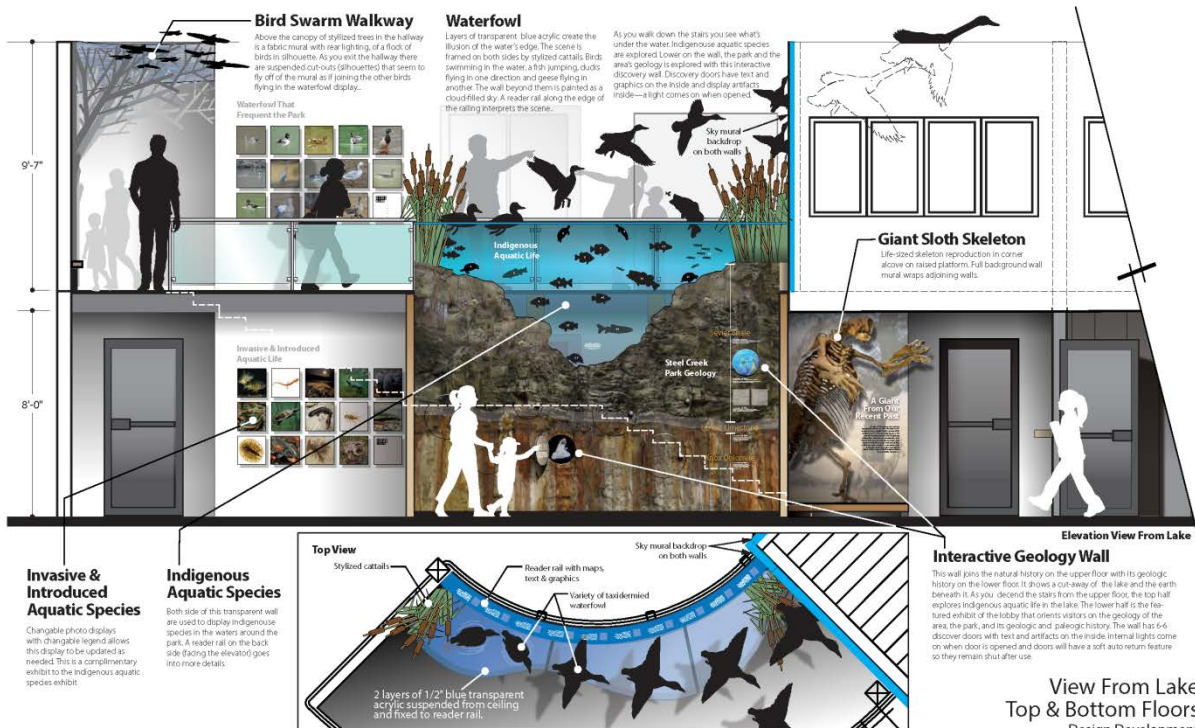

Invasive & Introduced Aquatic Species

Changeable photo displays
with a changeable legend allows
this display to be updated as
needed. This is a complimentary
exhibit to the indigenous aquatic
species exhibit.

Indigenous Aquatic Species

Both sides of this transparent wall
are used to display indigenous
species in the waters around the
park. A reader rail on the back
side (along the elevator) goes
into more details.

Top View

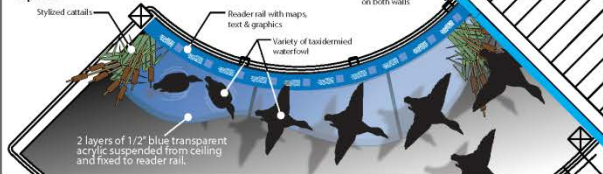

Interactive Geology Wall

This wall tells the natural history on the upper floor with its geologic
history on the lower floor. It shows a cut-away of the lake and the earth
beneath it. As you descend the stairs from the upper floor, the top half
explores indigenous aquatic life in the lake. The lower half is the featured
exhibit of the lobby that orients visitors on the geology of the
area, the park, and its geologic and paleogeologic history. The wall has 6-8
display doors with text and artifacts on the inside. Internal lights come
on when door is opened and doors will have a soft auto return feature
so they remain shut after use.

View From Lake Top & Bottom Floors Design Development



Partners/Consultants:

The Friends of Steel Creek Park
and the management staff of
The Nature Center at Steel Creek Park

Project:

May 25, 2016
Interpretive Exhibits for the 1st & 2nd
floors of the Nature Center at Steel Creek Park

Client:

The Friends of Steel Creek Park

Revisions:

1/16/2016
2/17/2016

Concept Document Only
Finality of design is not guaranteed
unless otherwise noted in this scope
of work or in a separate addendum

9

[Back to Page 1](#)

In Memory



Wallace Coffey (1/4/1940 - 9/27/2016)

We are sorry to share the sad news of the passing of local civic leader and life-long Bristol resident Wallace Coffey. Wallace was a Friends Board member from 2007 to 2016 (Honorary Board member 2013-2016). Coffey, along with Pat Vance, served as Co-Chairs of the original Steele Creek Park Vision Committee which began work July, 1996. The resulting 23-page report prepared by Wallace and Kevin Hamed and entitled, "A Vision for the Future," helped develop a common vision for the future of the newly-opened Steele Creek Park Nature Center and the diverse natural aspects of Stacy Grayson Memorial Park at Steele Creek. A direct result of the Committee's work was establishment of our Friends organization.

Coffey was a member of the Bristol Bird Club for 58 years and held numerous leadership positions within the birding community throughout Tennessee. He was recognized in 2009 for Distinguished Service by Tennessee Ornithological Society (TOS) and again in 2015 for 50 years of membership at the 100th Centennial Celebration of TOS. He co-founded the Mount Rogers Naturalist Rally and established the Shady Valley Cranberry Festival, which takes place every year on the second weekend of October. Wallace published several books on birds and ferns of the region, and provided leadership roles for several birding projects in both Tennessee and Virginia.

Some of you will remember Wallace from his 31 years with the Bristol Herald Courier as Marketing Director, or his 10 years of production work at WCYB-TV, or from his many civic leadership roles with the Bristol Area Chamber of Commerce, Viking Hall Civic Center, the Kiwanis Club of Bristol, the Autumn Chase Festival, Racefest and the United Way of Bristol. Others will remember him as a talented birder, naturalist, bird bander, conservationist, storyteller, mentor and great teacher.

"Here's to you, Wallace," said Dr. Andy Jones, Curator of Ornithology at the Cleveland Museum of Natural History. "You lived an exceptional life that had a positive impact on so many people, and you will be sorely missed." Jones, as well as the talented biologist Chris O'Bryan (who is working on his Ph.D. in Australia) were just two of the many young men Wallace mentored and shared his love of nature. Both Jones and O'Bryan had their first jobs as Park Naturalists at Steele Creek Park under the guidance and advisement of Wallace Coffey.

As the Friends of Steele Creek Park and Nature Center have begun fundraising efforts for the new expansion's displays, a plan is in the works to name one of the vibrant Bird Display in Wallace's honor. Should you wish to help with this noteworthy effort, please make checks payable to "Friends of SC Nature Center" with a notation "Wallace Coffey Fund." He was very pleased to know his long legacy of community education will live on at Steele Creek Park.

Tribute and photo by Michele Sparks

Fall Nature Center Activities

Friday and Saturday, October 7 and 8. [19th Annual Wildlife Weekend.](#)

Friday, 14 October, 5:00 pm. [Turtle Talk and Snakes Alive](#) – Meet Lance at the Nature Center for a moderate hike along the shores and into the woods in search of some of the park's most misunderstood residents, reptiles and amphibians!

Friday, 28 October, 4:00 pm. [Fall Colors Hike](#) – Meet Jeremy at the Nature Center for a moderately strenuous hike into the woods in search of fall colors and scenic vistas! We'll learn about some native wildlife along the way, too.

Friday, 11 November, 4:00 pm. [Winter Waterfowl of Steele Creek Park](#) – Meet Don at the Nature Center for a mild stroll looking for waterfowl, and many other migrants around the lake. Don't have binoculars? Borrow a pair of ours!

Friday, 02 December, 4:00 pm. [Winter Greenery Hike](#) – Meet Don at the Nature Center for a Holiday-themed adventure! Enjoy a mild hike in search of winter wonders including Christmas ferns, mistletoe, and hollies. Also, help find and collect the 2016 Christmas tree for our Nature Center!

You can keep up with what's going on at the Park and with Friends by liking us on Facebook or by following our webpage at <http://www.friendsofsteelecreek.org>.

We appreciate feedback about our communication. Let us know if you find these newsletters interesting and/or useful. If you have suggestions for topics to be covered, or other formats that we could use, let us know by e-mail at mail@friendsofsteelecreek.org.

If you prefer to not receive these newsletters, simply let us know at mail@friendsofsteelecreek.org.

[Back to Page 1](#)

The City of Bristol, Tennessee Parks & Recreation
Along with Friends of Steele Creek Nature Center & Park
present

19th Annual Wildlife Weekend

As We Grow...

Friday & Saturday, October 7 & 8, 2016

Friday, October 7th

6:30 pm - Welcome Reception

7:00 pm - Photography Show
featuring local amateur
photographers with awards and
reception sponsored by Friends of
Steele Creek Nature Center & Park

7:15 pm - Nature Center Expansion
update and preview

7:30 pm - "A Photojournalist's View of
Nature, the Sun, Moon and Stars"
with Marq Marquette

Saturday, October 8th

8:30 am - Early Bird Walk w Bristol Bird
Club

9:00 am - Bird Banding w Richard Lewis
and Rack Cross

10:00 am - "Patterns in Nature" a storybook
walk w Michele Sparks

11:30 am - Geology Hike w Lance Jessee

12:45 pm - Snake Talk & Walk
w Connie Deegan

2:30 pm - Mushrooms & Fall Flowers
w Gabrielle Zeiger

Saturday's Ongoing Exhibits & Activities (10:00am - 1:00pm)

Fossils w J.R. Arnold • Bugs w Eric Smith • Fossil Casting w ETSU Geosciences

• Birds of Prey w Bays Mountain • Skins & Skulls

• Nature Crafts w Friends of Steele Creek Nature Center & Park

Call (423-989-5616) or visit the Nature Center for more details.

Check-in for all activities is at the Steele Creek Park Lodge.

Bring your own lunch and enjoy the beauty of Steele Creek Park.



[Back to Page 1](#)

Nature Center Expansion Progress in Photos!



May 18



May 28



June 16



June 29



July 7



July 13



July 20



August 3



August 8



August 17



August 31



September 2



View from the lake (8/31/2016)



View from 2nd floor (9/2/2016)



Main Gallery Entrance (9/2/2016)